

# PBSS-905 / 1005 (S / D / T / Q)



- ❖ 強力曲肘式鎖模機構結合滾珠線性滑軌設計，性能卓越、效率高，特別適合高產量需求之容器生產。配合打溢料設備及機械手，可全自動高效率生產。
- ❖ 10" TFT 彩色LCD觸控螢幕人機介面電控系統，功能強、操作簡易、富人性化。
- ❖ Powerful, crank-type mold clamping system combined with linear motion guides for outstanding performance and high efficiency. This series is designed to meet high production requirements. Available to equip with auto deflashing device and take-out robot to achieve fully automatic, highly efficient production.
- ❖ 10" TFT colorful LCD touch screen with human-machine interface control system. It provides powerful functions, maximum operational convenience and user-friendly operation.



Model No.

Max. product capacity

Min./Max. dia. of product

Screw diameter

Screw L/D ratio

Inverter motor

Screw rotating speed

Extruding capacity

Outer diameter of die mouth

Mould center distance

Clamping force

Oil hydraulic drive motor

Dry cycle

Pressure of air

Compressed air consumption

Total power consumption

Machine net weight

Gross weight

Machine dimensions

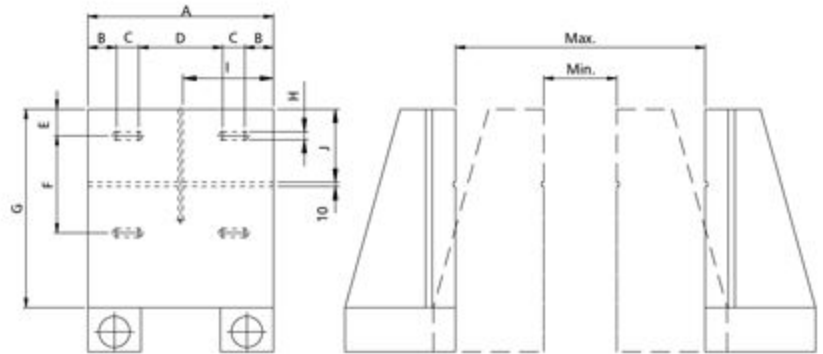

模板尺寸圖

MOLD PLATEN DIMENSIONS

UNIT:mm

NO.	Max.	Min.	A	B	C	D	E	F	G	H	I	J
PBSS-905	500	160	380	50	50	180	60	196	415	18	185	150
PBSS-1005	640	240	420	65	50	190	60	220	449	18	205	165

配合模內貼標機之使用、開關模尺寸另訂

For use with in-mold labeling machine. Open-close clamping mold is specified upon request.

型號	Unit	PBSS-905S	PBSS-905D	PBSS-905T	PBSS-905Q	PBSS-1005S	PBSS-1005D	PBSS-1005T	PBSS-1005Q
最大產品容量	C.C.	1,000-5,000	600-2,700	200-1,000	50-500	2,500-10,000	1,500-5,000	600-2,700	200-1,000
產品最小最大直徑	mm	75-200	60-140	30-100	20-80	100-250	80-180	60-140	30-100
螺桿直徑	mm	90	90	90	90	100	100	100	100
螺桿比例		24/1	24/1	24/1	24/1	26/1	26/1	26/1	26/1
普通馬達	HP	60	60	60	60	75	75	75	75
螺桿轉速	r.p.m.	15-65	15-65	15-65	15-65	15-65	15-65	15-65	15-65
押出量	kg/hr	140	140	140	140	180	180	180	180
模嘴外徑	mm	150	80	50	40	200	135	80	50
模中心距	mm	~	160	120	100	~	250	160	120
鎖模壓力	ton	10.3	10.3	10.3	10.3	16.8	16.8	16.8	16.8
泵浦驅動馬達	HP	25	25	25	25	40	40	40	40
空循環	sec.	4.8X2	4.8X2	5X2	5X2	5X2	5X2	5.2X2	5.2X2
空氣壓力	kg/cm <sup>2</sup>	6-8	6-8	6-8	6-8	6-8	6-8	6-8	6-8
空氣消耗量	L/min	2,000	2,000	2,000	2,000	2400	2400	2400	2400
總電力	kw/h	86.6	88.4	89.4	91.1	108.1	113.2	116.6	119.9
機械淨重	kg	10,000	10,000	10,000	10,000	12,000	12,000	14,000	14,000
裝箱毛重	kg	12,000	12,000	12,000	12,000	13,500	13,500	15,500	15,500
機械尺寸	m	4.6x4.4x2.8	4.6x4.4x2.8	4.8x4.5x2.8	4.8x4.5x2.8	5.3x6.2x3.2	5.3x6.2x3.2	5.6x6.2x3.2	5.6x6.2x3.2

以上規格如因設計變更恕不另行通知

All specifications and designs are subject to change without notice.